

TELEOST.



OVERVIEW

LENGTH

49.1m | 161'1"

BUILDER

Feadship

BUILT

1998 / 2023

CREW

10

CABINS

5

GUESTS

12

DRAFT

2.74m | 9'

BEAM

8.51m | 27'11"

CRUISING

11 Knots

FUEL

160 L/HR

RANGE

4,500 nm

GRT

487



TELEOST.

49m FEADSHIP

TELEOST is a classic Feadship with enduring appeal. Built in 1998 and extensively refitted in 2023, she combines pedigree craftsmanship with modern upgrades and is presented in immaculate condition. With a flexible five-cabin layout for up to 12 guests and one of the most established crews in the charter market, she is a yacht with a proven reputation for delivering exceptional charters.

Her expansive decks are designed for easy outdoor living, from a sun deck with Jacuzzi, daybeds and bar, to generous lounging and dining areas aft. Inside, her interiors are warm and elegant, with refinished woodwork and flexible accommodation for up to 12 guests.

TELEOST is also one of the most capable yachts in the region for active charters. A full Nitrox dive programme with compressors and tanks, supported by an extensive collection of toys including eFoils, seabobs, waverunners and a waterslide, ensures guests can make the most of every moment on and in the water.

With a loyal crew, Feadship craftsmanship and a refit that leaves her in immaculate condition, TELEOST is ready to deliver exceptional charters across Australia, New Zealand and the South Pacific.



KEY FEATURES

Feardship pedigree with timeless exterior and interiors

Major 2023 refit: new paint, AV/IT systems, generators & full soft furnishings

Flexible accommodation for up to 12 guests in 5 cabins

Dedicated dive set-up with Nitrox system, compressors & full gear inventory

Expansive sun deck with Jacuzzi, lounging and dining options

Long-standing, highly experienced crew with exceptional charter reputation

Extensive toy line-up: eFoils, waverunners, seabobs, waterslide, kayaks & more

TENDERS

22 ft / 6.95 m centre console Zodiac Open 7 with Yamaha 250hp outboard engine (flexible platform for diving, fishing and water sports). Max capacity 16, including crew

• 18 ft / 5.5 m centre console Zodiac Open 5.5 with Yamaha 130hp outboard engine. Max capacity 12, including crew

TOYS

2 x eFoils (Lift Foils 5'6" boards)

2 x 3-man Yamaha wave runners (4 stroke)

2 x Seabob F5S

3 x Inflatable paddleboards

1 x Inflatable windsurf board (can also be used as paddleboard)

Extensive fishing gear

TOYS

Snorkeling gear

3 x wakeboards

1 x wake surfboard

3 x pairs waterskis (large, s/m & children)

2 x Individual slalom waterskis

Assorted inflatable toys (banana towable, 2 x donut ring inflatables, 1 x Large Mable couch inflatable)

2 x single kayaks

2 x double kayaks

1 x Hobie Mirage double pedal / paddle kayak

10 metre custom inflatable waterslide from bridge deck

Assorted beach toys (sunshades, volleyball etc.)

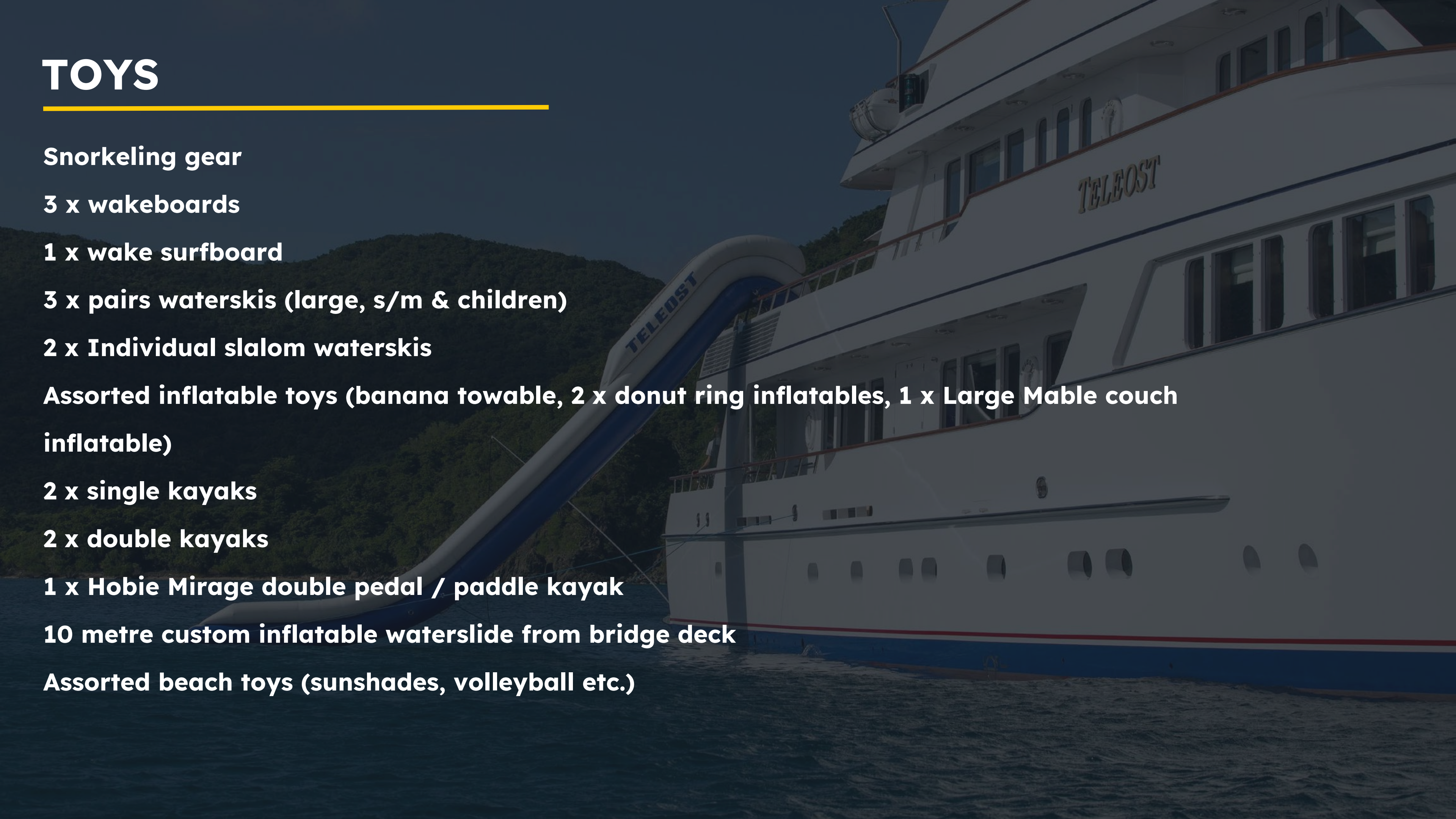

SCUBA DIVING

2 x Compressed Air and Nitrox compressors (Nitrox up to 40% oxygen for certified divers)

Cascade breathing gas storage for fast tank refills

Hyperlite 1 Hyperbaric Chamber for onboard treatment of dive medical emergencies in remote areas

Zodiac Open 7 tender with custom dive ladder for easy access

18 x scuba tanks (12 & 15 litre sizes)

8 x BCDs

8 x Suunto Dive computers

Wetsuits (3 mm & 5 mm)

Crew include Dive Instructor, Dive Master and Rescue Divers

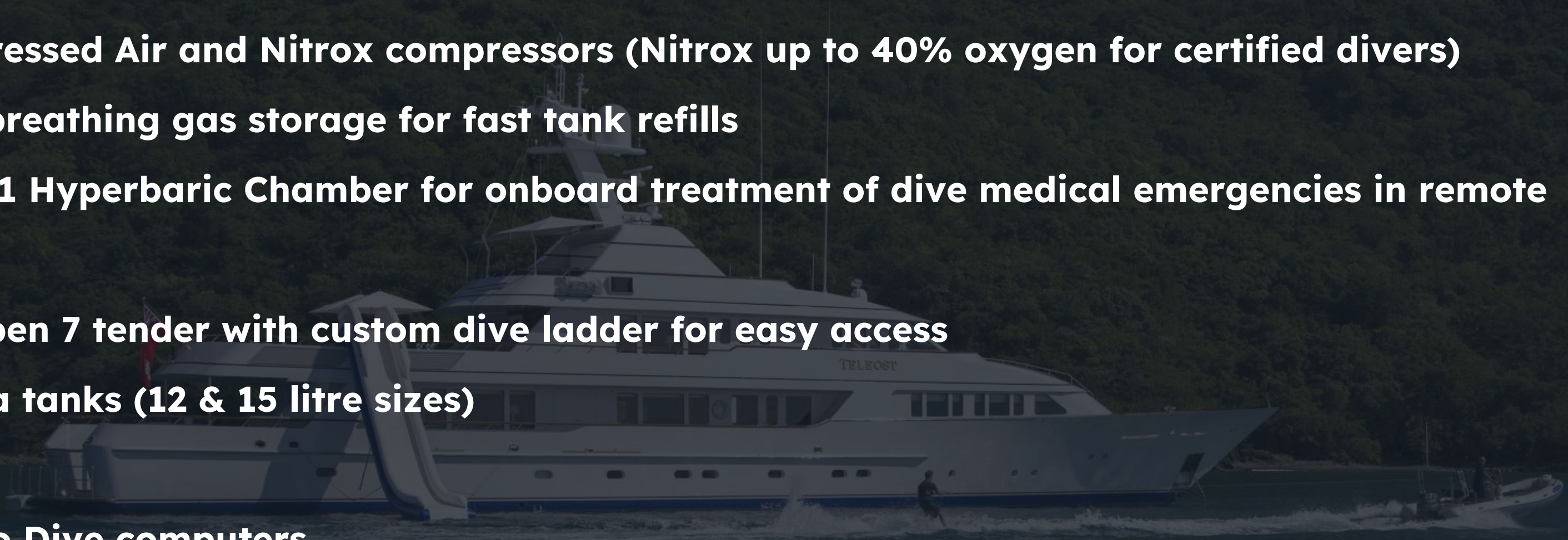



SUNDECK
TELEOST



SUNDECK
TELEOST



SUNDECK
TELEOST



SUNDECK
TELEOST



SUNDECK

TELEOST



UPPER DECK AFT

TELEOST



UPPER DECK AFT

TELEOST



UPPER DECK SALON

TELEOST



UPPER DECK SALON

TELEOST



UPPER DECK BAR

TELEOST



MAIN DECK DINING TABLE

TELEOST

A wide-angle photograph of a luxurious yacht's main deck saloon. The room features two large, light-colored patterned sofas facing each other, with several patterned throw pillows. In the center is a glass-topped coffee table with a decorative vase. The room is surrounded by large windows and a glass door leading to an outdoor deck, offering a view of the ocean at dusk. The interior is finished with dark wood paneling and recessed ceiling lights. A yellow horizontal line is positioned below the text.

MAIN DECK SALOON

TELEOST



MAIN DECK SALOON

TELEOST



MAIN DECK DINING

TELEOST



MAIN DECK MASTER CABIN

TELEOST



MAIN DECK MASTER CABIN

TELEOST



MAIN DECK MASTER CABIN

TELEOST



LOWER DECK DOUBLE CABIN

TELEOST



LOWER DECK DOUBLE CABIN

TELEOST



LOWER DECK TWIN CABIN 1

TELEOST



LOWER DECK TWIN CABIN 2

TELLOST

FOR CHARTER

TELEOST





FOR CHARTER

TELEOST



TELEOST

TELEOST

FOR CHARTER

TELEOST



IMO 1006219

TELEOST

TELEOST.

GENERAL ARRANGEMENTS

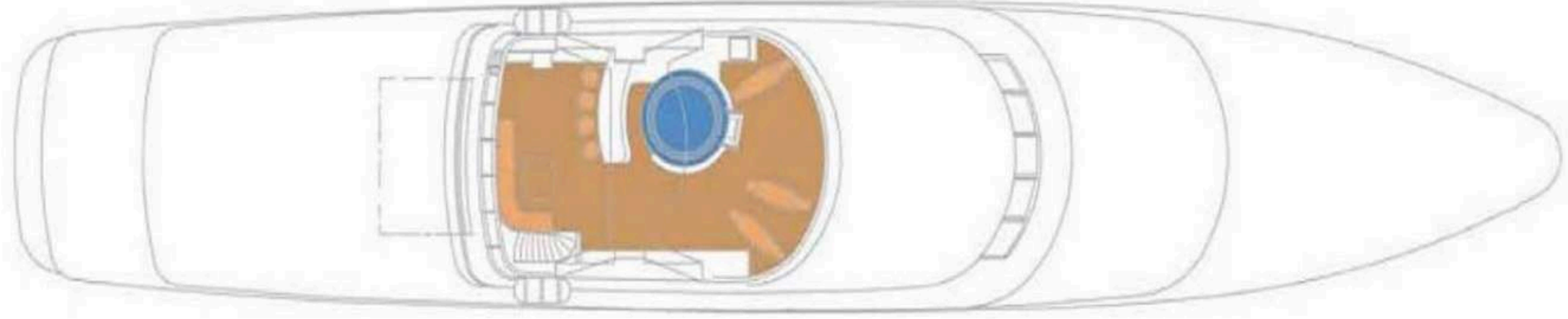

SUNDECK

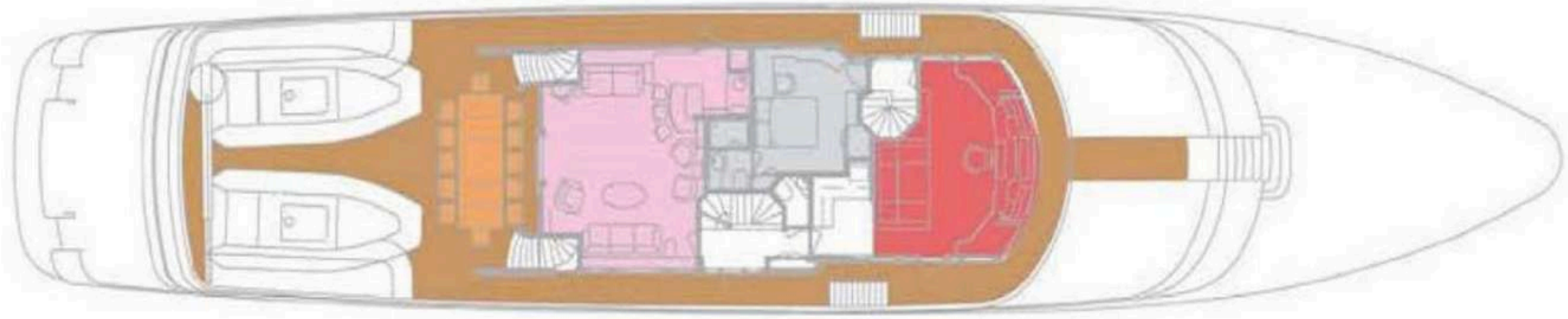

UPPER DECK

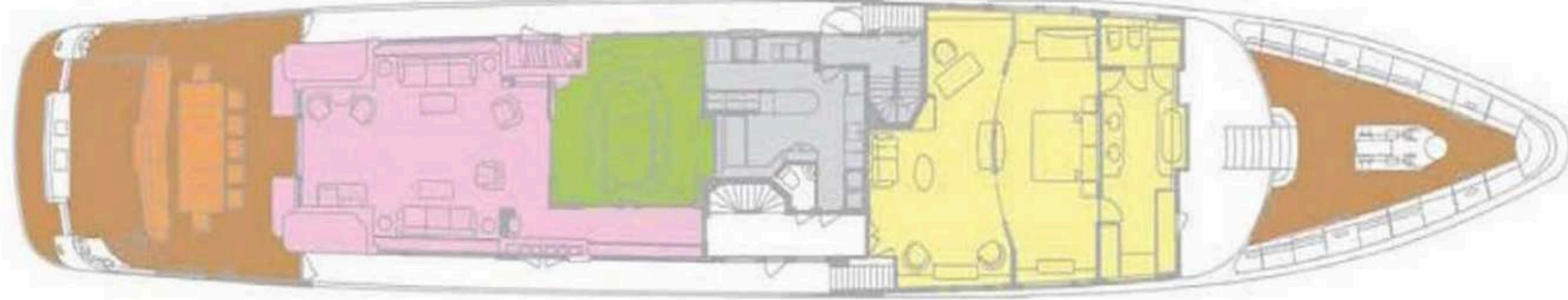

MAIN DECK



LOWER DECK

TELEOST.