

PLEIADES II





ABOUT

Introducing Pleiades II, a 110ft classic beauty with upmarket modern Australian interiors, delivering vacations to remember and the perfect environment to unwind.

Uniquely spacious, she is able to accommodate up to 10 guests in five luxury staterooms and boasts sophisticated interiors, as well as vast deck space for relaxing and sunbathing. With cruising range of 4,000 nautical miles she is the ideal super yacht for exploring the breathtaking East Coast of Australia!





As the Pleiades star cluster rises, it signals the start of Matariki, the Māori New Year. Matariki is about celebrating the present and looking forward to the future while remembering the past.

We invite you onboard Pleiades to create memories for the future with your nearest and dearest.

PLEIADES II

SPECIFICATIONS

YACHT

33m Kingship

YEAR BUILT

2007 Refit 2019

LENGTH

33M / 110FT

YACHT TYPE

MOTOR

CRUISING SPEED

10 Knots

CREW

3 Permanent + 3

CRUISING AREA

East Coast of Australia

CABINS

5

OVERNIGHT GUESTS

10 (12 upon approval)

DAY GUESTS

12



Lower Deck

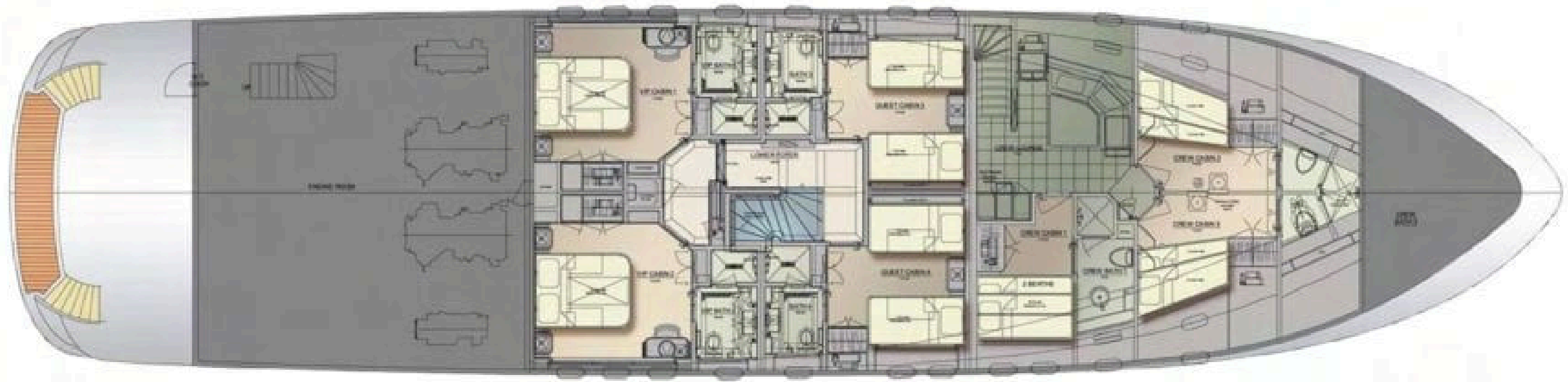

Main Deck



Upper Deck

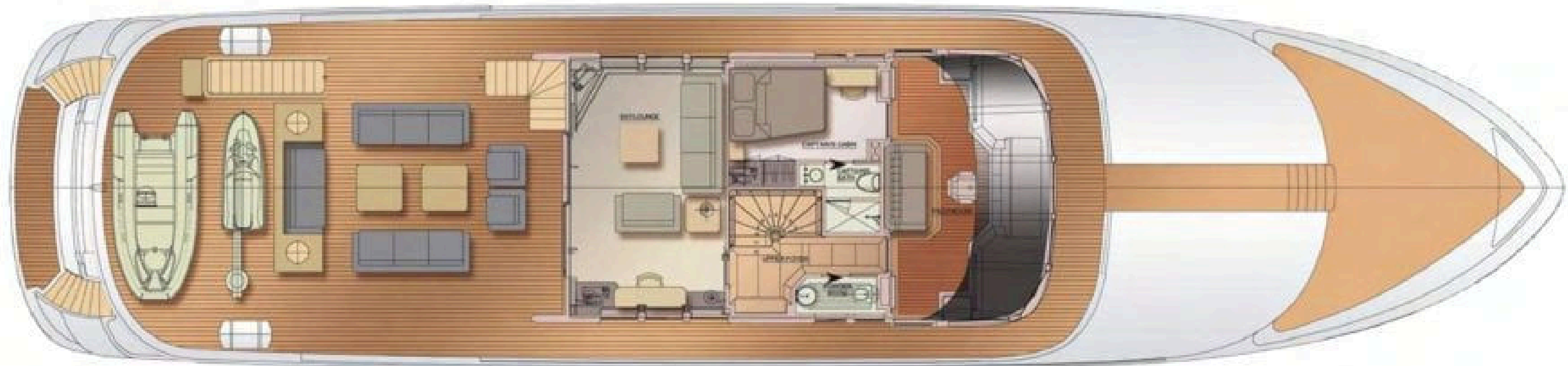

Charter Rates*

LIVEABOARD CHARTER RATES - ALL INCLUSIVE*

Overnight Charter (24 hours)	\$19,500
2 night charter	37,000
3 night Charter	\$50,000
4 night charter	\$62,000
5 night charter	\$74,000
6 night charter	\$86,000
7 night Charter	\$98,000
Hamilton Island Relocation & Marina Charge	\$3,000

CURRENT INCLUSIONS

- Coral Sea Marina (Airlie Beach) pick up
- Rates are for 10 guests (12 on approval) - surcharge for additional adults
- Private use of Pleiades II with 6 professional crew
- Standard ship catering offered as family style or plated meals, three times per day along with snacks/morning & afternoon tea meal offerings
- 5 staterooms each with ensuite offering superior comfort and relaxation.
- Each stateroom is equipped with deluxe natural amenities, hair dryers, bathrobes and slippers.
- Televisions in each cabin
- Jacuzzi, 2 x Stand Up Paddle Boards, Snorkel Equipment, 2 x Underwater Scooters
- Variety of non-alcoholic beverages

*Rates are all inclusive, without alcoholic beverages (BYO)
During peak season, the vessel has a two-night minimum and rates are subject to public holiday surcharges
Overnight rates reduced considerably from 3 nights as our preferred minimum charter length

Itinerary Sample - 3 Night Charter

DAY 1

Coral Sea Marina Cid Harbour

Depart Coral Sea Marina for a 1.5 hour cruise, towards Cid Harbour – Sawmill Beach where you will spend the rest of the day.

Take a tender ride around the bay to see the sights, before enjoying afternoon canapes and watch the sun go down from this stunning location.

Highlights:

- Peak Walk
- Afternoon canapes
- Sunset Drinks on Sundeck
- Dinner on the Aft

DAY 2

Cid Harbour Butterfly Bay Stonehaven

Wake up on day two to the incredible cabin views of Cid Harbour, before indulging in a breakfast feast to fill your stomachs before taking on the infamous Whitsunday Peak track!

A walking track from Sawmill beach leads to the summit of Whitsunday Peak. The track is a strenuous 2.5km (437m climb) 4 hour round trip. Alternatively a more sedate 1.5km trail takes you around the point to Dugong beach.

Depart mid-morning, the vessel will head North taking in the magnificent contours and headlands of Hook Island. Our recommendation is Butterfly Bay, for some perfect snorkelling locations!

Once you are snorkelled out, head back South towards the overnight anchorage of Stonehaven and enjoy a tender ride around or watersports for the afternoon!

Highlights:

- Lookout walk
- Snorkeling locations
- Watersports
- Beach picnic location



DAY 3

Langford Island Whitehaven Beach

After a morning walk and snorkel at Langford Island, the stunning sand spit - sit back and relax for a longer cruise around to Whitehaven Beach.

Take in the sights of Whitsunday Passage as you cruise through Hook Island around to Whitsunday Island, heading towards to world famous white sandy beach, with the first stop at Tongue Point to see Hill Inlet.

A short tender ride (tide permitting) to the start of a walk the leads to the lookout overlooking Hill Inlet. Once ashore it is just 650 meters to the platform lookout with a magnificent view straight into Hill Inlet where the sands just beneath the water swirl to give incredible contrast.

Anchor overnight at Tongue Bay or on the South side of Whitsunday Island at Chance Bay for protection from southerly winds.

Highlights:

- Sand Spit
- Snorkelling
- Watersports
- Hill Inlet Walk
- Whitehaven Beach

DAY 4

Whitehaven Airlie Beach

Wake up to the beautiful colours of Whitehaven, before departing for a cruise back to Coral Sea Marina for your transfer to the airport/further accommodation on land!

*Please note, this is a sample itinerary. Routes may be reversed, and locations might change based on weather conditions.

OUR CREW ENDEAVOUR TO VISIT GUESTS PREFERRED LOCATION, HOWEVER FINAL CRUISING ITINERARY IS AT CAPTAINS DISCRETION BASED ON CONDITIONS DURING THE CHARTER PERIOD.



PLEIADES II

CREW



CAPTAIN

ROSS HEGINBOTHAM

Captain Ross has been on the water for most of his life, growing up in Sydney he then moved to QLD and worked at Sea World as a water-skiier in the famous ski shows! Ross obtained his first commercial tickets in 1980 and worked on many of the cruise boats on the Gold Coast before heading North to Hamilton Island and further up to Cairns. He also has lived in Europe, working onboard superyachts around Spain & Nice in the south of France for many years. Ross has spent the last 7 years with the same company rotating between a fleet of yachts along the East Coast of Australia. The Whitsundays is a second home to Ross and he can't wait to show you around this beautiful part of the world. When at home, he likes to spend time with family, travelling, diving and snow skiing. Make sure you ask him about his car!

PLEIADES II

CREW



CHIEF STEWARDESS

CHRISTINE LUKE

Meet Christine, hails from the Country Music Capital of Australia, Tamworth NSW. Tamworth, nestled far from the ocean's embrace, may raise curiosity about Christine's affinity for the sea. However, at the age of 22, Christine bid farewell to the melodies of country music and embraced a new chapter of her life in the coastal paradise of Port Macquarie. It was there that she discovered her profound love for the majestic ocean.

Embarking on a journey to pursue her dreams, Christine ventured into the world of aviation as a flight attendant with Qantas, dedicating three memorable years to the flying kangaroo. Following her adventurous spirit, she sought new horizons and embarked on a twelve-year excursion to Hong Kong, immersing herself in the vibrant energy of this bustling city and exploring destinations across the globe.

Upon her return to Australia in 2020, fate beckoned Christine into the captivating realm of the yachting industry. Just like a fish takes to water, she effortlessly transitioned into her role as Chief Stewardess, embracing the art of curating unparalleled experiences for her guests. In her leisure time, Christine enjoys spending time with her partner, embarking on new adventures, savoring exquisite wines, indulging in delicious cuisines, and of course, immersing herself in the water and all its wonders.

Christine's remarkable creative flair is a source of immense pride, as she is committed to delivering service of the highest caliber. Her unwavering dedication is centered around ensuring that your time aboard becomes an extraordinary and cherished memory, enveloped in exclusivity and unparalleled bliss.

PLEIADES II

GALLERY

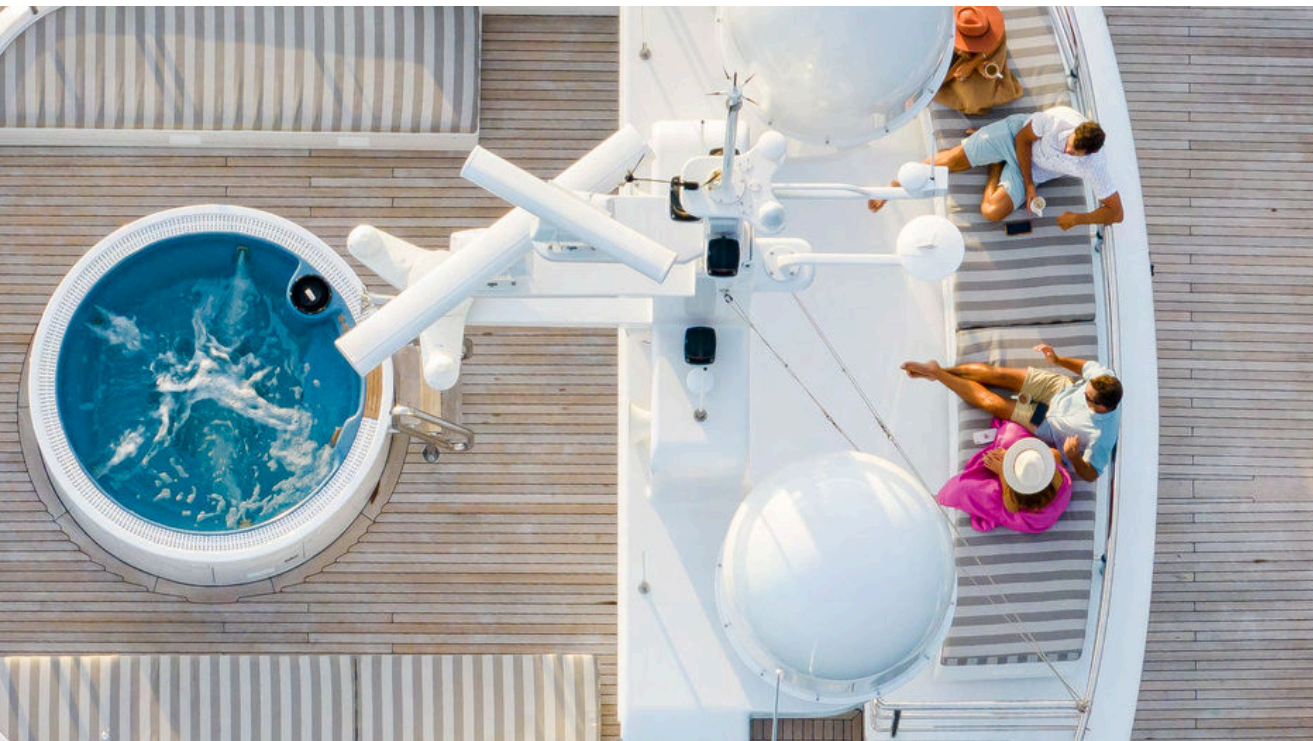

PLEIADES II

GALLERY

