

EXPLORE



DREAM

DISCOVER



INTRODUCING 4A

## The Invitation

Mediterranean elegance. South Pacific beauty.

Welcome aboard 4A. Crafted in Italy by Sanlorenzo and winner of the prestigious Superyacht of the Year award, she has been tailor-made for those who expect more from their time at sea.

With a Mediterranean soul and a South Pacific spirit, 4A carries 10 guests across Australia, New Zealand, and the wider South Pacific — the Whitsundays, the Great Barrier Reef, New Zealand's coastline, and from there across to Fiji, French Polynesia, and beyond.

She moves with the seasons. The crew knows these waters well. And a charter aboard her is not a holiday you book and forget. It is one you talk about for years.



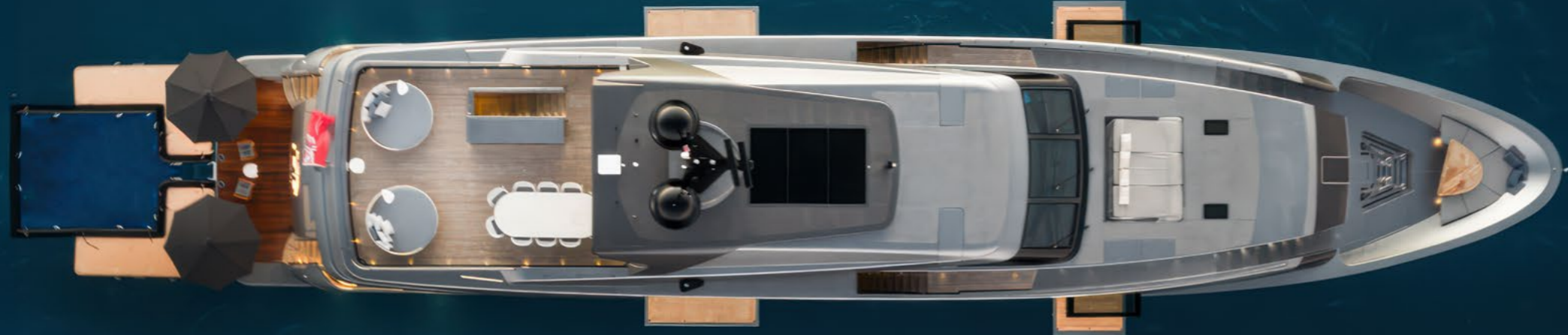

## VESSEL OVERVIEW

## Introducing 4A

At 39.4 metres, 4A is a rare combination of design pedigree and modern performance. Built entirely from aluminium, her metallic silver hull and clean, sculpted lines turn heads in every harbour.

Her fold-down balconies in the saloon and master suite bring the ocean into your living space, while her full-beam aft deck beach club delivers a barefoot-to-water experience unlike any other. The sun deck, complete with bar, daybeds, BBQ, and awning, is made for afternoons that melt into evenings.

And when it's time to get in the water, a full kit awaits — Seabobs, paddleboards, snorkelling gear, and a complete scuba setup backed by a certified SSI dive school with onboard instruction. For getting further, faster, 4A is supported by a purpose-built day boat in Australian waters, with equivalent explorer vessel support available across Fiji and French Polynesia. A new MKII tender, purpose-built for the full South Pacific circuit, is currently in final design stages. For younger guests, a secure netted pool sits at water level.

## LENGTH

39.4m | 129'3"

## BUILT

2007 / 2018

## CABINS

5

## DRAFT

9'4 | 2.85m

## CRUISING

13 Knots

## MAJOR REFURBISHMENT:

2024

## Toys Include:

- 2 x Seabobs
- 4 x Stand-up paddleboards
- Full snorkelling gear
- Complete scuba diving equipment
- SSI certified dive school – onboard instruction available
- Purpose-built day boat and fishing vessel (Australian waters)
- Explorer vessel support available in Fiji and French Polynesia
- MKII Explorer Tender – in build, South Pacific circuit ready
- 5.3m Novurania outboard tender

## BUILDER

Sanlorenzo Yachts

## CREW

6

## GUESTS

10

## BEAM

8.8m | 28'10"

## TOP SPEED

28 Knots

DESIGN & BUILD

## Italian Craft, Pacific Spirit

4A's design is the product of Sanlorenzo's unmatched craftsmanship. Her pure lines, balanced proportions, and metallic silver hull are instantly recognisable from afar. Inside, her layout is open and inviting, designed for a natural flow between spaces and a seamless connection to the sea.

Awarded Superyacht of the Year in 2008, 4A represents the pinnacle of Mediterranean design sensibility – now perfectly attuned to the Australian and wider South Pacific lifestyle.



SOUTH PACIFIC

## Cruising Grounds

4A is based in Australia but she does not stay still. The Whitsundays and the Great Barrier Reef are home for part of the year. New Zealand's coastline for another. And when the season turns, she heads north and east — into Fiji, across to French Polynesia, and through the islands of the South Pacific.

The circuit is the point. The crew moves with the seasons and knows every region well. Wherever you board, you are in the right hands.



An aerial photograph of a coral reef system. The water transitions from a deep blue in the open ocean to a lighter turquoise near the reef. The reef itself is a complex, dark structure with various textures. In the upper right, a small, green, rocky island is visible. The text 'THE SOUTH PACIFIC' is overlaid in white, serif font across the middle of the image.

THE

SOUTH

PACIFIC

FIJI AND THE SOUTH PACIFIC

## The Circuit

4A moves with the seasons. From Australia and New Zealand, she heads north and east as the year turns — into Fijian waters, across to French Polynesia, and through the islands of the South Pacific.

Fiji and French Polynesia are not extensions of the itinerary. They are the itinerary. The decision to charter 4A in the South Pacific is a decision to go somewhere most people never reach — and to do it without compromising anything.

The South Pacific circuit covers some of the most extraordinary cruising grounds on earth. Fiji's Yasawa and Mamanuca Islands stretch across 300-plus islands and islets — reef diving, village visits, surf breaks, and anchorages you will not share with another boat. French Polynesia stretches across an area the size of Western Europe. Tahiti, Moorea, Huahine, Raiatea, Taha'a, Bora Bora — each one distinct, each one worth a week of anyone's time.

The Fiji dry season runs May through October. French Polynesia, June through September. Both regions book well ahead. The guests who commit early get the best weeks. Across every region 4A travels, the crew works with a network of local guides — dive operators, reef specialists, cultural hosts, and people who have spent their lives on these waters. That network is part of what a charter aboard 4A provides.



FIJI

## Bula

Fiji is 333 islands scattered across warm, still water. Most visitors see one resort on one island and call it Fiji. Charter guests aboard 4A see something else entirely.

The dry season runs May to October. Average days hit 28°C, water sits at 25°C, and the Yasawa and Mamanuca Islands are at their clearest and calmest — near-12 hours of daylight and enough wind to move comfortably between anchorages.

Fiji is the Soft Coral Capital of the World. That is not marketing language. The reefs here carry more soft coral colour and density than anywhere else on earth. Dive sites run from shallow coral gardens accessible to beginners through to Beqa Lagoon's shark dives for the experienced. Manta rays gather at Naviti Island — up to 13 sighted at once. The visibility is exceptional.

4A is a certified SSI dive school — with a Divemaster captain and a fully dive-qualified crew including a dedicated SSI instructor aboard. The Yasawa Islands are one of the finest places on earth to learn. A guest who arrives never having dived can leave with an SSI Open Water certification earned in water that experienced divers travel specifically to reach.

Beyond the onboard capability, 4A maintains relationships with local expert guides throughout the regions she travels. In Fiji that means dive operators who know the reef systems intimately, cultural guides who open village doors that stay closed to passing tourists, and local knowledge that no itinerary document can fully capture.

Above the waterline, the culture is equally worth your time. A Kava ceremony with a village chief is not a tourist experience when the crew knows the right village and the right introduction. A Lovo feast — food cooked underground in a Polynesian earth oven — is a meal you will not forget. The people here are genuinely warm, and genuine access to that warmth takes local knowledge. 4A's crew has it.

The Yasawa Islands run 80 kilometres from north to south. The Blue Lagoon is here. Champagne Beach is here. Cloudbreak — one of the world's most respected left-hand surf breaks — is just off Tavarua Island in the Mamanucas. The circuit holds more in a week than most guests expect.



FIJI — A WEEK IN THE ISLANDS

## How a Week Here Feels

A Fiji charter aboard 4A does not follow a fixed timetable. The Yasawa and Mamanuca Islands run 80 kilometres from the Mamanucas in the south to the top of the Yasawa chain in the north, and the general direction of travel is northward — but what happens along the way belongs to the people aboard.

Most charters begin near the Mamanucas. The heart-shaped silhouette of Tavarua Island appears early — home to Cloudbreak, one of the world's great left-hand surf breaks. For those who don't surf, the reef and the anchorage are reason enough to slow down and start here.

The tender — the Beast, 4A's purpose-built day boat — is what makes the islands accessible. The yacht anchors. The Beast goes. To the reef, to the surf break, to a beach that took twenty minutes to find. It changes the radius of what a week here covers.

The week tends to find its own shape from that point. There are reefs worth a full day in the water. There are sandbars that appear at low tide and belong entirely to you. There are anchorages quiet enough that the only sound by midnight is the water against the hull.

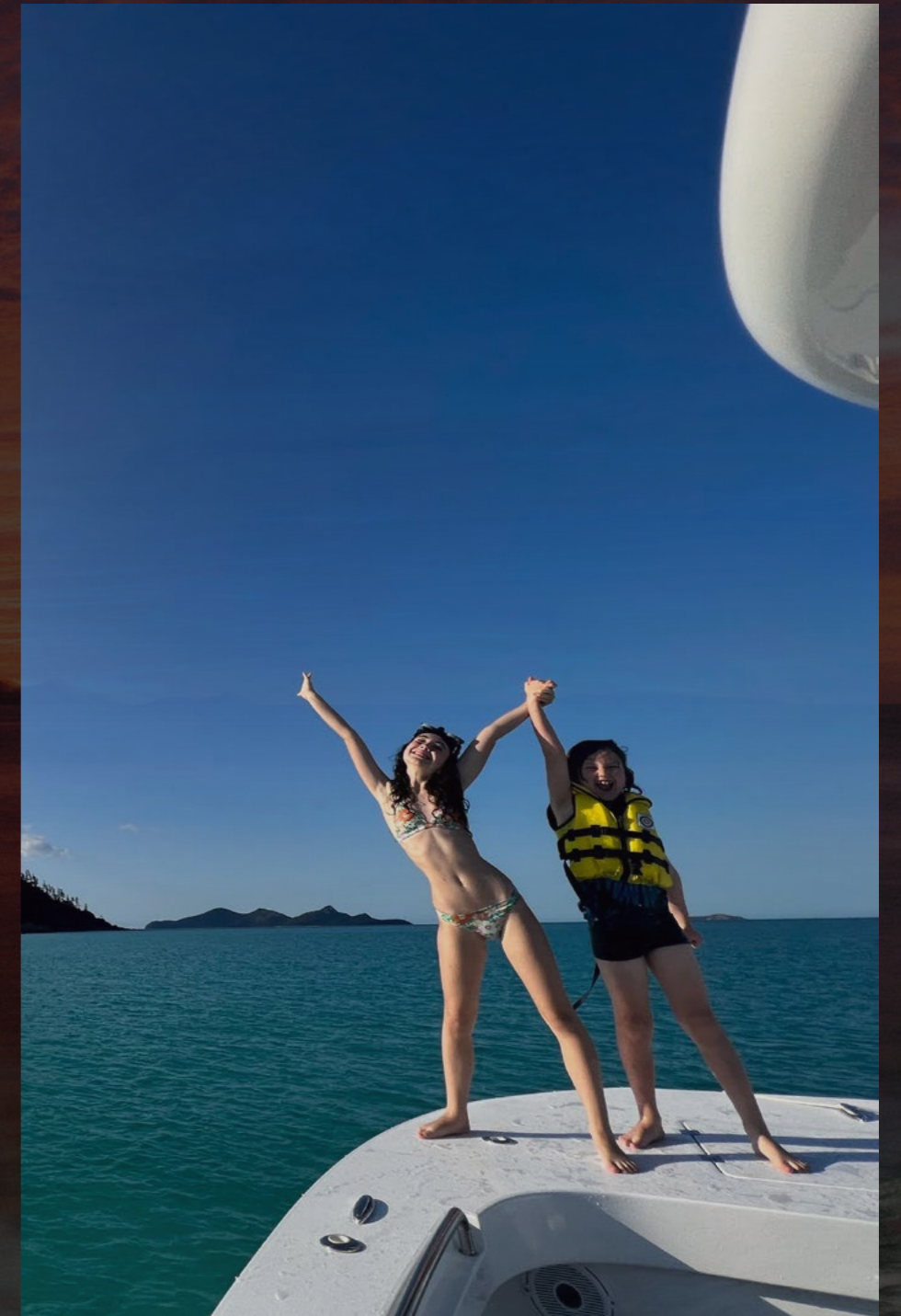

## FIJI — A WEEK IN THE ISLANDS

## Three things worth building a week around:



## The manta rays at Naviti Island.

A cleaning station in Cuvu Bay draws mantas in numbers that are hard to believe until you are in the water with them — up to 13 sighted at once in the right conditions. This is not a guaranteed encounter, but it is one of the most consistent in Fiji, and worth positioning the week around.



## A village Kava ceremony in the northern Yasawas.

At Yasawa-i-Rara, near Champagne Beach, the local village hosts guests for a Meke dance performance and a traditional Kava ceremony — yaqona root presented to the chief, coconut shell in hand, the way it has always been done in these islands. It is a genuine exchange, not a resort activity. The beach BBQ beforehand, with reef sharks visible in the shallows below, is the kind of afternoon that earns its own story.



## The Blue Lagoon at Nanuya Levu.

The water here is the colour that makes people distrust photographs. Sawa-i-Lau Island is nearby — limestone caves with an underwater passage that opens into a hidden chamber, guided by locals who grew up swimming it. Some guests spend two nights here and don't feel like they've wasted a day.

FIJI — A WEEK IN THE ISLANDS

The week closes the way it opened — slowly.

The southern islands on the way back carry their own character, and the right anchorage on the last night is whichever one the group hasn't been able to leave.



## FRENCH POLYNESIA

## Further Still

French Polynesia is 118 islands and atolls spread across an area nearly the size of Western Europe. Getting there takes commitment. Once there, you understand why people have been trying to find words for it since the first European ships arrived.

The Society Islands are the heart of a 4A itinerary in this region — Tahiti, Moorea, Huahine, Raiatea, Taha'a, and Bora Bora, each one distinct in character and worth taking slowly. The prime charter window runs June through September, when trade winds are consistent, humidity drops, and the water is clear and settled at 27°C.

Moorea arrives 19 nautical miles from Papeete — a short morning passage to an anchorage in Cook's Bay framed by volcanic peaks that rise straight from the water. Huahine is quieter, greener, and largely untouched by the kind of development that has found other islands. It is considered one of Polynesia's most intact — ancient marae temples still standing in the hills, fish traps in the lakes built centuries ago. Raiatea is sacred ground; Marae Taputapuātea, a UNESCO-listed temple complex, is the spiritual centre of the entire Polynesian diaspora.

Taha'a is the vanilla island. The scent reaches the boat before the anchorage does. Bora Bora closes the circuit — Mt Otemanu rising above a lagoon in every shade of blue, manta rays at the cleaning stations, a final dinner on the aft deck with the last of the western light going gold across the water.

This is a region where the distances between islands reward an unhurried pace. Ten days is the right duration. The crew knows it and plans accordingly.

FRENCH POLYNESIA — TEN DAYS IN THE SOCIETY ISLANDS

## Papeete to Bora Bora

The Society Islands run roughly 400 kilometres from Tahiti in the east to Bora Bora in the west. A ten-day charter covers the full arc — Papeete, Moorea, Huahine, Raiatea, Taha'a, and Bora Bora — at a pace that lets each island reveal itself properly.

The route is the same one sailors have been making since the first European ships found these waters. What changes each time is everything else — the group aboard, the conditions, the decision to stay one more night in a bay that earned it. Ten days gives that room. Seven is possible. Ten is better.

Most charters start in Papeete and end at Bora Bora, or the reverse. Both work. The islands are distinct enough in character that the order of discovery changes the experience meaningfully.

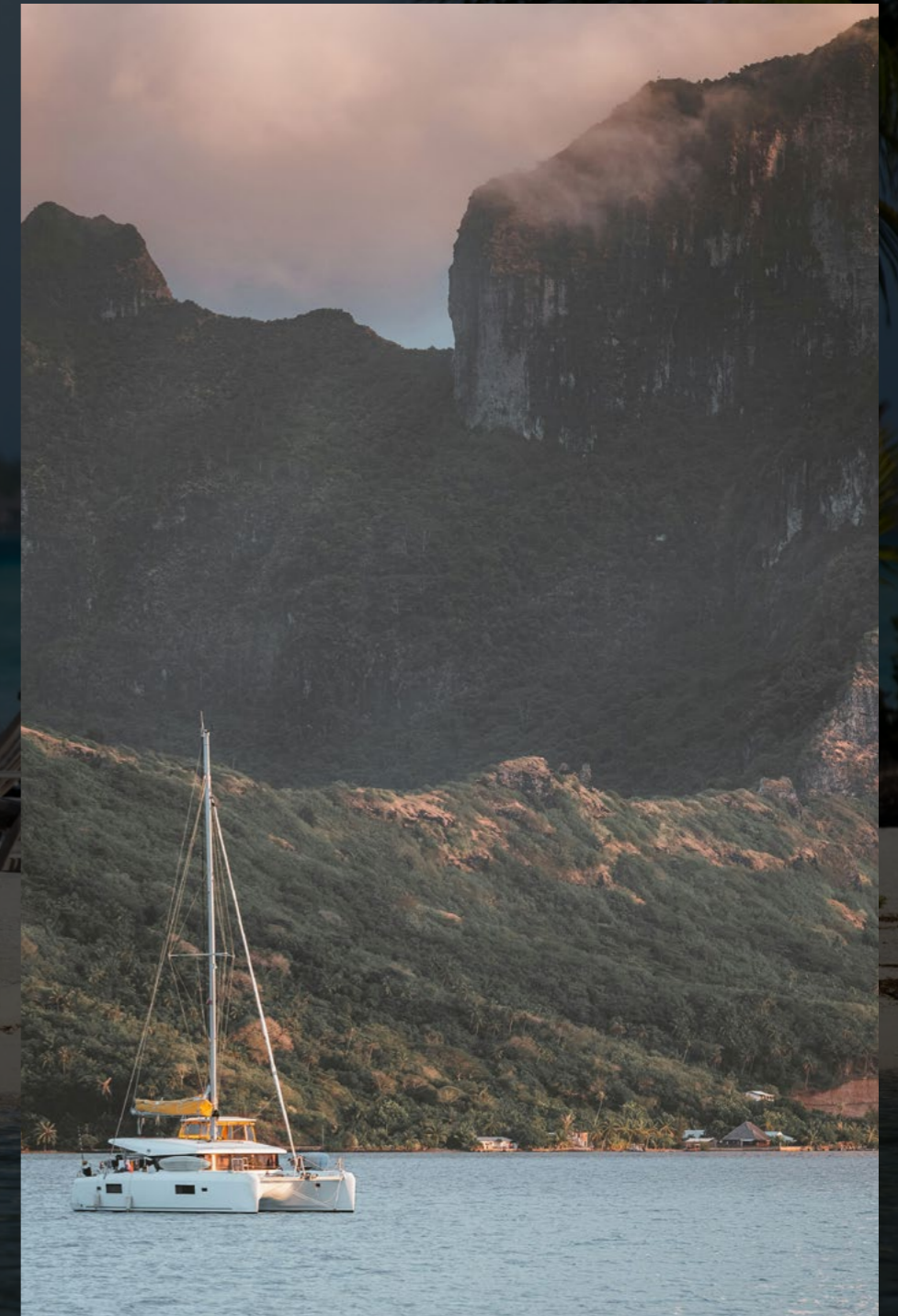

## FRENCH POLYNESIA — TEN DAYS IN THE SOCIETY ISLANDS

## Three things that define the circuit:



The overnight passage to Huahine.

4A departs Moorea at dusk and covers the open water to Huahine through the night — Southern Cross overhead, no lights on the horizon, warm air, flat water. It is one of those passages that becomes part of the story of the trip. Arriving into Avea Bay at first light, the anchor going down in turquoise water with the island still quiet, is how a French Polynesia charter should begin its second chapter.



Marae Taputapuatea on Raiatea.

The great temple complex at the southeastern point of Raiatea is the spiritual heart of all Polynesia — the place from which the Polynesian diaspora navigated outward to Hawaii, New Zealand, and Easter Island centuries ago. It sits on a point of land between the lagoon and the open sea, UNESCO-listed and largely unvisited. A morning here, before the tourist boats arrive from the resorts, carries a particular weight. The Faaroa River nearby is the only navigable river in the Pacific island chain — worth an hour by tender into the interior.



Taha'a, the vanilla island.

Raiatea and Taha'a share the same barrier reef and the crossing between them takes minutes. But Taha'a is a different island entirely — quieter, less visited, and planted with vanilla orchid fields that make the air on the approach thick with scent. The coral gardens between the motus here are among the finest snorkelling in the circuit. Anchor off a private sandbank for the night and there is nothing between you and the reef but water.

## FIJI — A WEEK IN THE ISLANDS

Bora Bora closes the circuit.

Mt Otemanu rises above the lagoon in a way that photographs genuinely understate. The manta ray cleaning station at Anau is one of the most consistent encounters in French Polynesia.

The last evening on the aft deck, the mountain going dark against the sky, is a good place for a charter to end.





THE

LIVING

SPACES

# Upper Deck Ponte Superiore

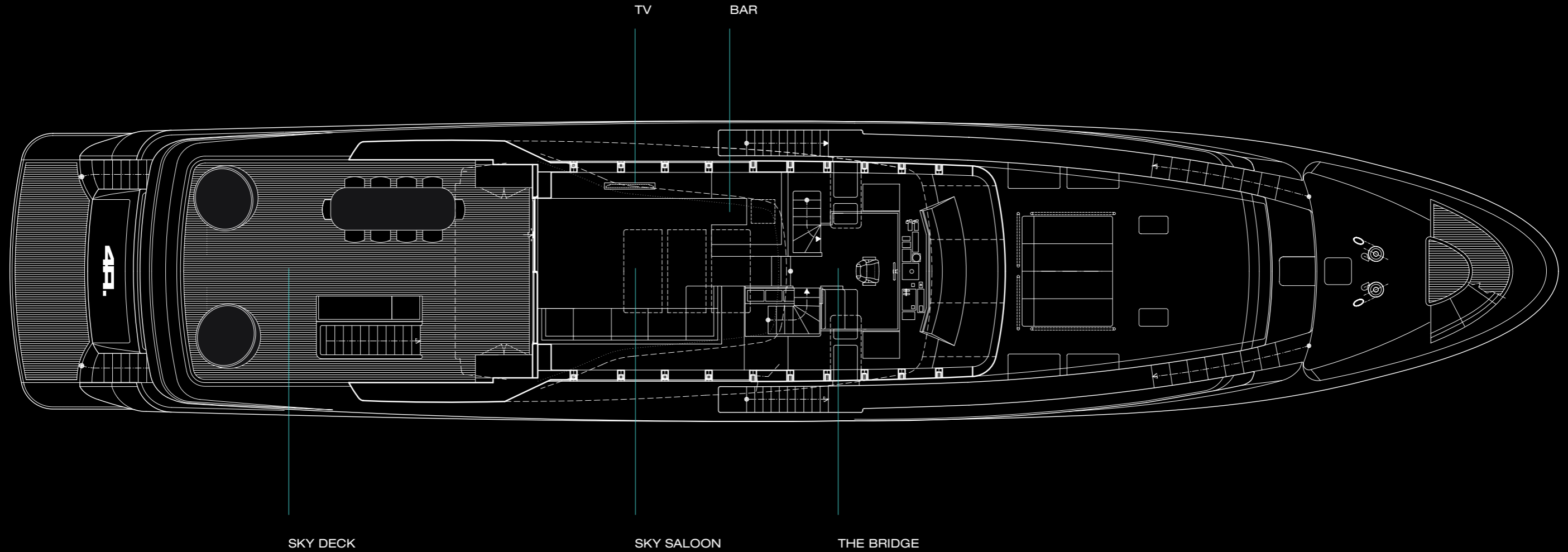

# Main Deck Ponte Superiore

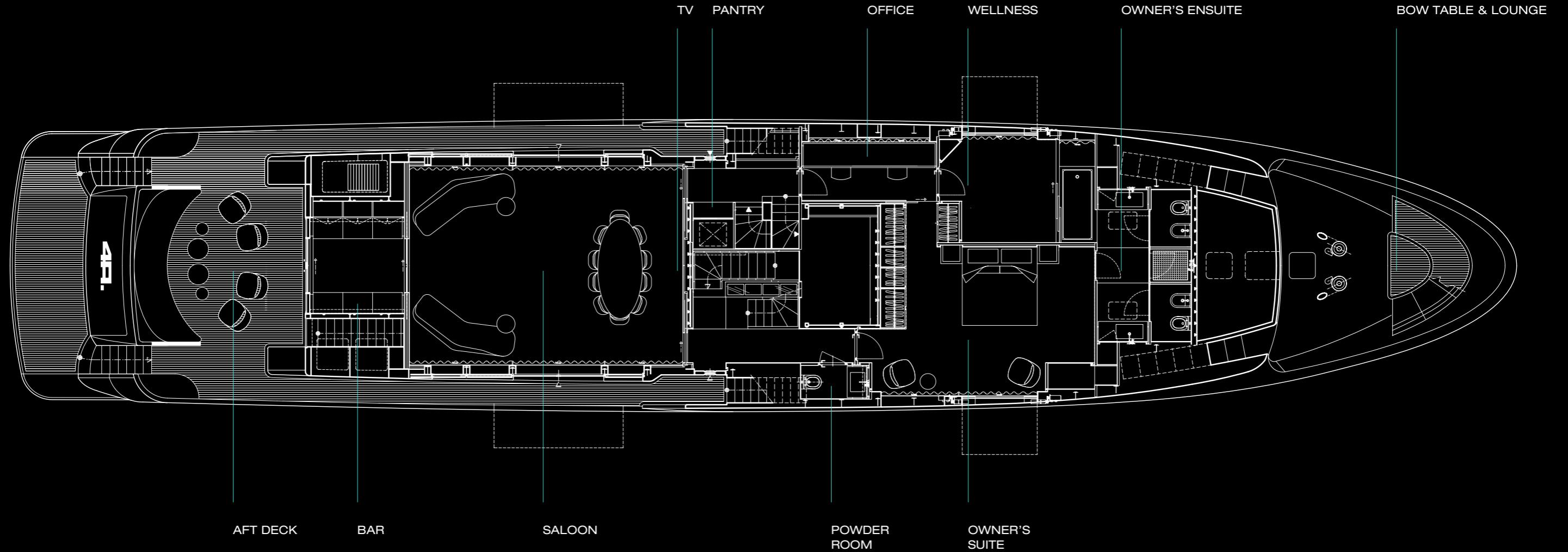

# Lower Deck Ponte Superiore

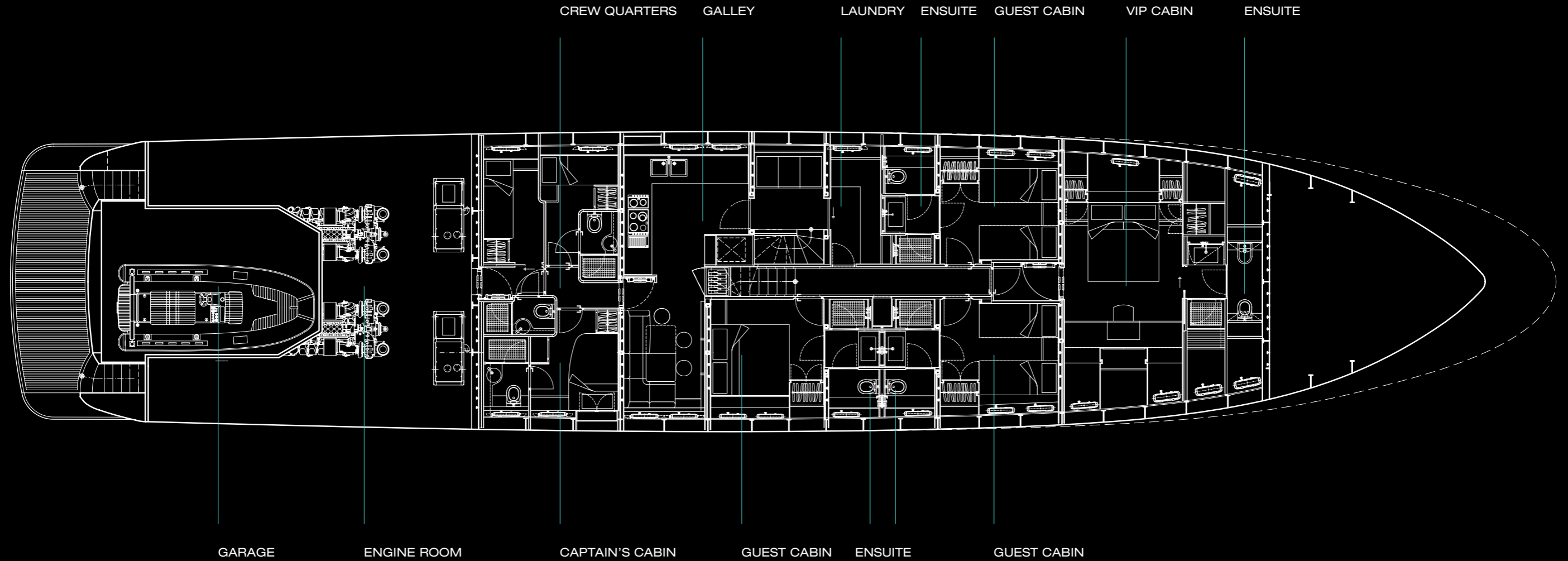

SIGNATURE FEATURE

## The Owner's Retreat

Occupying the full beam, the Owner's Suite is a private apartment afloat. Large windows frame panoramic views that can be opened to the sea breeze or closed for perfect privacy.



The suite includes twin bathrooms, a full soaking bath, a steam shower, a separate study, and a dedicated wellness room. Every detail has been designed to create a retreat within a retreat — a space where mornings begin with coffee on the private balcony, afternoons linger in the bath, and evenings close with the quiet hush of the ocean outside.







BRIDGE &amp; OBSERVATION

## The Captain's View

Step into the yacht's command centre, where modern navigation meets old-world romance. From here, you can watch as 4A charts her course — whether weaving between the coral reefs of the Whitsundays or approaching the dramatic sandstone cliffs of the Kimberley. It's a rare perspective — the captain's own — and a reminder that every great journey is guided by expertise and vision.



THE LIVING SPACES

## Light, Flow & Atmosphere

Natural textures, soft tones, and panoramic windows create an interior that feels both elevated and effortless. 4A's open-plan design encourages movement, connection, and the constant presence of light and sea.



SALOON DINING

## A Table for Ten

Meals aboard 4A are as memorable as the destinations. The saloon dining table seats ten, framed by fold-down balconies that can open to the ocean air.



The onboard chef works closely with you to create menus inspired by your tastes and dietary preferences — from multi-course degustations with paired wines to relaxed, family-style feasts. Produce is sourced locally, and the yacht's wine cellar is stocked with exceptional vintages.



## SALOON LOUNGE

## A Place to Unwind

The saloon lounge is where days end and evenings begin. Large windows draw in the light, while deep, inviting seating creates a natural gathering place.

Here, guests might share cocktails at sunset, curl up with a book, or watch a film on a quiet night at anchor. It's a space that adapts to your mood, whether lively and social or peaceful and still.





SKY DECK & SKY LOUNGE  
Above It All

From the sky deck, the world seems to open around you. Here, daybeds invite lazy afternoons, the wet bar keeps drinks within reach, and the BBQ tempts with the scent of fresh seafood.



Swivel lounge pods can be turned toward the sun, the view, or the conversation — the perfect perch for everything from sunrise yoga to stargazing. Inside, the Sky Lounge is an all-weather haven with sweeping views and a casual, welcoming energy.





Bathed in natural light from expansive glass skylights, the Sky Lounge is an elevated retreat offering sweeping 360-degree views of sea and sky.

By day, it's the perfect vantage point to watch the world drift by. By night, it transforms into an intimate entertainment space, complete with plush seating, a state-of-the-art TV and sound system, and a front-row view of the stars. Whether hosting cocktails, enjoying a film, or simply relaxing with the horizon all around you, the Sky Lounge is where comfort meets spectacle.



## AFT DECK LOUNGE

## Sea Level Serenity

The aft deck lounge is a shaded, alfresco haven just above the waterline. It's where lunches stretch long into the afternoon and evenings dissolve into the sparkle of stars on the water.

From here, steps lead directly to the swim platform – the threshold to the sea and all the adventures it holds.



## BOW DECK &amp; SUNBEDS

## Front Row to the Horizon

At the bow, the world opens wide. The sunbeds invite long, languid hours beneath open skies — a secluded retreat for quiet mornings, afternoon daydreams, or watching the day fade into dusk. It's the most peaceful place on board, where the sea stretches endlessly ahead and time seems to slow with every gentle rise and fall of the bow.



## VIP SUITE

## Second To None

Generous in size and discreet in location, the VIP Suite offers a king bed, private ensuite, and abundant natural light. Perfect for a secondary couple or VIP guest, it balances privacy with proximity to the yacht's main living areas.



## GUEST CABINS

## An Elegant Retreat

A king cabin offers an inviting retreat for friends, family, or young adults. Elegant yet understated, it features its own ensuite, ample storage, and refined details that elevate the space beyond simple comfort — creating a private haven designed to make every moment on board feel exceptional.



## GUEST CABINS

## Your Space, Your Way

Two twin cabins offer flexible arrangements for friends, family, or children. Each features its own ensuite, generous storage, and thoughtful touches that make every guest feel considered.



## WELLNESS &amp; RETREAT ZONE

## For the Body &amp; Soul

The Wellness & Retreat Zone is your sanctuary at sea – an elevated waterside space designed for movement, mindfulness, and complete immersion in your surroundings. Begin the day with a workout as the reef shimmers below, or unwind with a sunset stretch on the fold-down balcony, the horizon bathed in gold.



Every element invites connection with the ocean — to swim, to dive, or simply to pause and watch the light dance across the water.

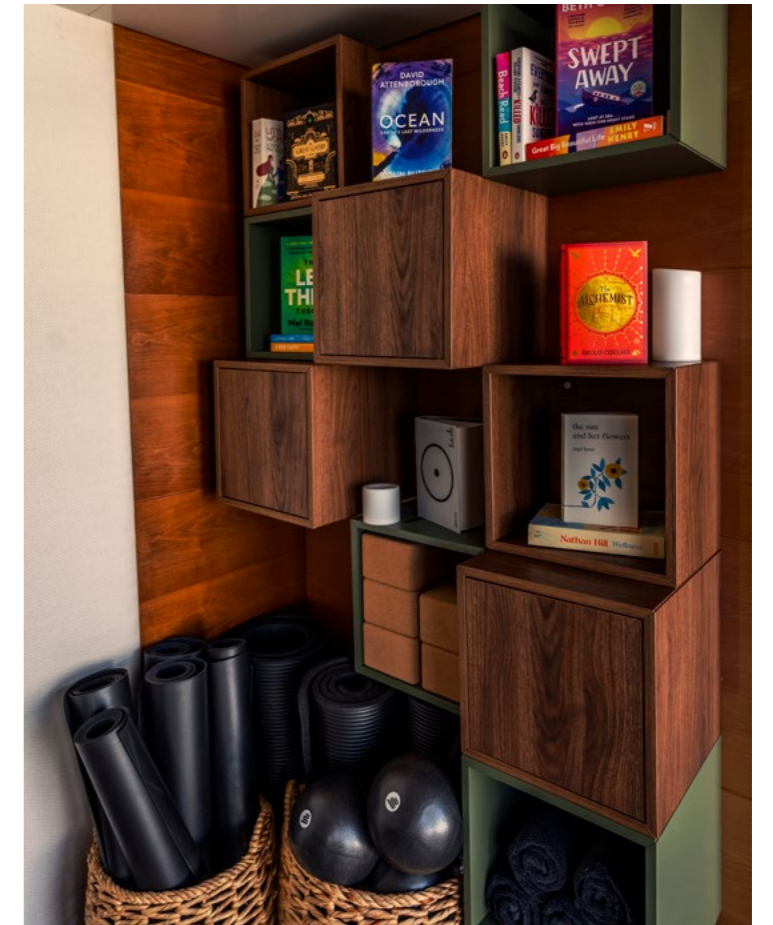

BEACH CLUB &amp; POOL

## No Sand Required

Step down to 4A's Beach Club and discover your private gateway to the sea. At its heart, a secure, netted pool offers all the pleasure of ocean swimming with none of the hassle — crystal-clear water, no sand underfoot, and a gentle embrace of safety for younger guests.



By day, it's a lively playground where children can splash under watchful eyes, or where adults can cool off between dives and paddles. By late afternoon, it transforms into a tranquil retreat — a place to float in peace, sip something chilled, and watch the sun paint the water in gold and rose.

Whether you're seeking quiet contemplation or a safe spot for family fun, the Beach Club and pool bring you closer to the ocean in complete comfort.



EXPLORE

ABOVE

BELOW

## WATER TOYS &amp; ADVENTURE

## For the Adventurer

Adventure is never far on 4A. Glide silently beneath the surface on a Seabob, skim the reef on a paddleboard, or take the tender to a deserted beach.

For divers, the crew can guide you through some of the most pristine underwater landscapes in Australia and the South Pacific.

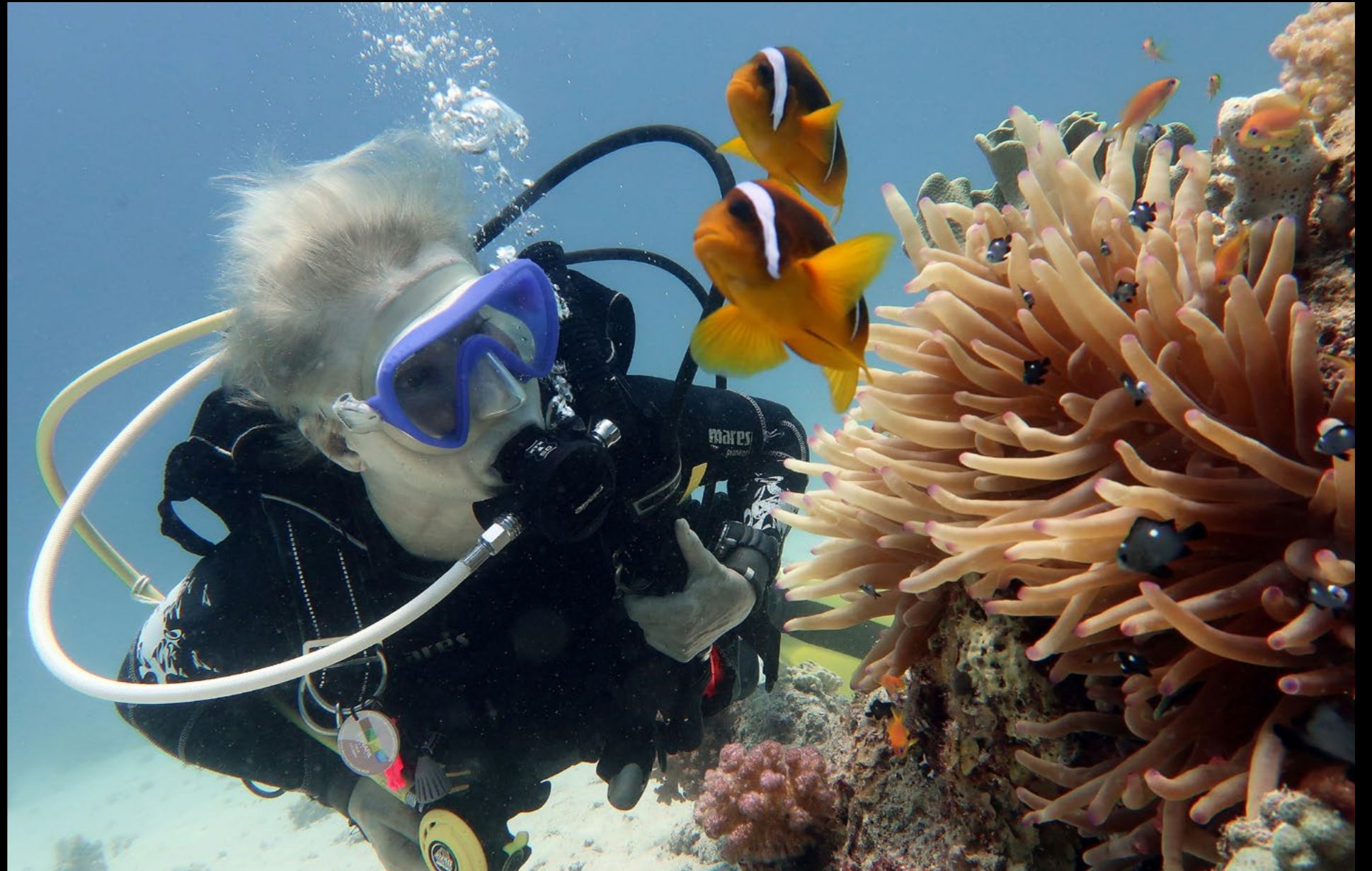

DIVE

## Learn Here. Dive Here

4A is a certified SSI dive school. Captain Johnny holds his Divemaster certification, and Rebecca — Deck/Stew and certified SSI dive instructor — brings full onboard teaching capability to every charter.

A guest who has never dived can complete their SSI Open Water certification aboard, in some of the clearest and most biodiverse water on earth. The Whitsundays, the Great Barrier Reef, and the Yasawa Islands in Fiji are not incidental backdrops to a dive course. They are the reason to do it here rather than anywhere else.



For certified divers, the onboard capability is one part of the picture. The other is the network. Across every region 4A travels, the crew maintains relationships with local expert guides — dive operators, reef specialists, cultural guides, and fishermen who know waters that no chart adequately describes.

These connections are what turn a good charter into an exceptional one, and they have been built over years of time in these regions.

ON THE WATER

## The Beast. And What Comes Next.

Most charter yachts carry just a tender. 4A is supported by the Beast — a purpose-built day boat and fishing vessel that has already proven its worth as a dive platform, activity base, and the fastest way to reach a beach, a reef, or a break that the yacht can't get close to.

The Beast is built for use. It goes where the conditions call for it and comes back loaded — with fish for lunch, with guests who have spent the morning on a reef, or simply with cold drinks from a beach that took twenty minutes to find and two hours to leave.



A new, purpose-built MKII Explorer Tender is currently in final design stages with the same builder — designed specifically for the full South Pacific circuit.

In the meantime, 4A accesses experienced explorer vessel support across Fiji and French Polynesia — locally based, region-specific, and operated by crews who know these waters intimately. The capability is there. The reach does not change.

CREW &amp; CONCIERGE

## Service Without Parallel

Danni Ramsay hails from Victoria, Australia and brings both polish and personality to life on board. She began her career at an award-winning winery and fine dining venue, mastering the art of impeccable service and developing a sharp eye for the perfect wine pour. After refining her skills in luxury resorts, she traded solid ground for the sea — and never looked back.

With fine dining finesse, resort-level organisation, and unmistakable Aussie charm, Danni runs a tight ship while keeping the atmosphere relaxed and warm. She believes great service should feel effortless — a little indulgent, and always genuinely felt.



4A

## Your Journey Awaits

The moment you step aboard, the outside world slips away. Days unfold entirely at your pace, and nights are lit by stars untouched by city lights.

From the turquoise lagoons of the Whitsundays to the vibrant reefs of the Great Barrier Reef, through the waters of New Zealand — and when the season turns, across to Fiji, French Polynesia, and the wider South Pacific — your journey begins with a single step onto the deck of 4A.

The Fiji dry season runs May to October. French Polynesia opens in June. Both are worth planning well ahead of time. If the South Pacific is on your radar for 2026/27, we would love to show you what a week aboard 4A looks like.



4A.